



apparecchio di illuminazione da parete e picchetto per interni ed esterni IP65. realizzato in alluminio ossidato e verniciato a polvere, composto da una testa cilindrica di diametro Ø80mm h.126mm orientabile di 360° lungo l'asse verticale e 90° lungo l'asse orizzontale.

modelli:

p2 parete soffitto diametro Ø80mm,

p2 parete soffitto con scatola contenente alimentatore 240V 50-60Hz incluso,

p2 picchetto con asta diametro Ø20mm h.45mm fuori terra,

p2 picchetto con asta diametro Ø20mm h.830mm fuori terra.

cablato con sorgente elettronica 3000K fino a 24,2W 3033lm.

ottiche: 22°

alimentatore in corrente costante escluso, da installare remoto.

finiture: bruno antico, nero notte, scurodivals e grigio argento.

IP65 rated wall and stake light fitting for indoor and outdoor use. made of powder coated and oxidised aluminium, consisting of diameter Ø80mm h.126mm cylindrical head adjustable by 360° on the vertical axis and by 90° on the horizontal axis.

versions:

p2 parete soffitto for wall and ceiling mounting with diameter Ø80mm,

p2 parete soffitto for wall and ceiling mounting with a box containing the 240V 50-60Hz power supply included,

p2 picchetto stake with a diameter Ø20mm rod h.45mm above the ground,

p2 picchetto stake with a diameter Ø20mm rod h.830mm above the ground.

wired with 3000K led source up to 24.2W 3033lm.

optics: 22°

constant current power supply not included, to be installed remotely.

finishes: antique brown, night black, scurodivals and silver grey.



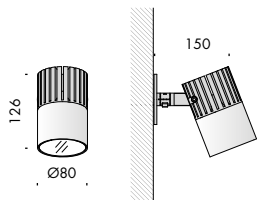

p2 parete soffitto			IP65	☆	CE	i
Vb6.565.01	bruno antico · antique brown	3000K	22°	0,9		
Vb6.565.03	nero notte · night black	3000K	22°	0,9		
Vb6.565.05	scurodivals	3000K	22°	0,9		
Vb6.565.07	grigio argento · silver grey	3000K	22°	0,9		

Ra	ies tm-30		sdc	mA	V _f (min)	lm	W	lm/W	
90	Rf 90	Rg 100	step 2	350	30,1	1630	11,3	144	A++
				500	31,0	2255	16,7	135	A++
				700	32,1	3033	24,2	125	A++
tm011	les19	☉	Ta25 °C	vita media · average life	50000 h	L70	B10		

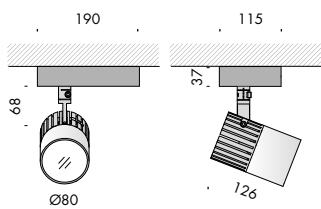
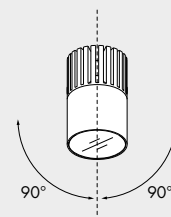
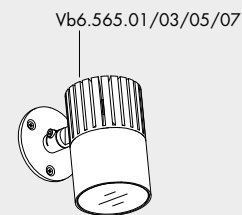

p2 parete soffitto		240V 50-60Hz	A	IP65	☆	CE	i
Vb6.565.09	bruno antico · antique brown	3000K	22°	1			
Vb6.565.11	nero notte · night black	3000K	22°	1			
Vb6.565.13	scurodivals	3000K	22°	1			
Vb6.565.15	grigio argento · silver grey	3000K	22°	1			

Ra	ies tm-30		sdc	mA	V _f (min)	lm	W	lm/W	
90	Rf 90	Rg 100	step 2	700	32,1	3033	24,2	125	A++
tm011	les19	☉	Ta25 °C	vita media · average life	50000 h	L70	B10		

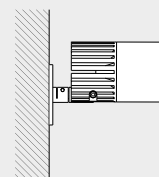
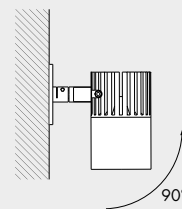

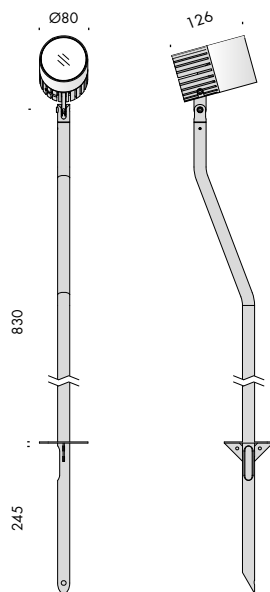
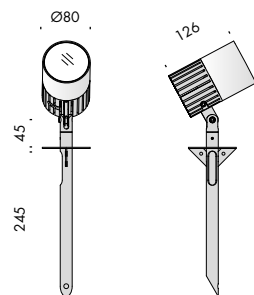
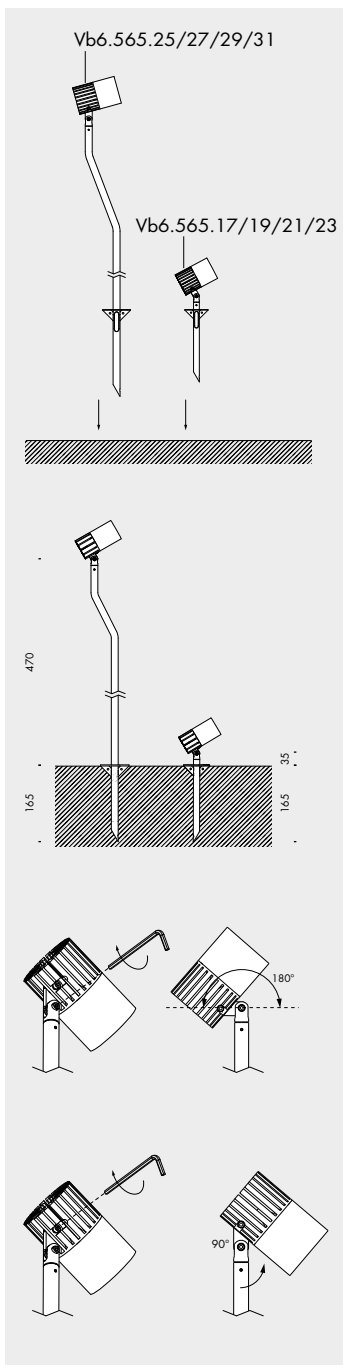

p2 picchetto 45

Vb6.565.17	bruno antico · antique brown	3000K	22°	1,4
Vb6.565.19	nero notte · night black	3000K	22°	1,4
Vb6.565.21	scurodivals	3000K	22°	1,4
Vb6.565.23	grigio argento · silver grey	3000K	22°	1,4

Ra	ies tm-30		sdc	mA	V _{f (min)}	lm	W	lm/W	
90	Rf 90	Rg 100	step 2	350	30,1	1630	11,3	144	A++
				500	31,0	2255	16,7	135	A++
				700	32,1	3033	24,2	125	A++
tm011	les19	Ta25 °C	vita media · average life	50000 h	L70 B10				

p2 picchetto 830

Vb6.565.25	bruno antico · antique brown	3000K	22°	2,2
Vb6.565.27	nero notte · night black	3000K	22°	2,2
Vb6.565.29	scurodivals	3000K	22°	2,2
Vb6.565.31	grigio argento · silver grey	3000K	22°	2,2

Ra	ies tm-30		sdc	mA	V _{f (min)}	lm	W	lm/W	
90	Rf 90	Rg 100	step 2	350	30,1	1630	11,3	144	A++
				500	31,0	2255	16,7	135	A++
				700	32,1	3033	24,2	125	A++
tm011	les19	Ta25 °C	vita media · average life	50000 h	L70 B10				



cavi con connettore femmina m8. cables with m8 female connector. IP67 ☆ CE ï

f9.250.70	150mm	0,01
f9.164.86	2000mm	0,1
f9.164.87	5000mm	0,2
f9.164.88	10000mm	0,3



cavi con connettori m/f m8. cables with m8 m/f connectors. IP67 ☆ CE ï

f9.250.72	2000mm	0,1
f9.250.73	5000mm	0,3
f9.250.74	10000mm	0,6

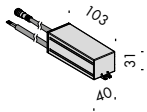

alimentatori. power supplies. 240V 50-60Hz A IP67 CE ï

t4.411	15W	350mA	0,2
---------------	-----	-------	-----

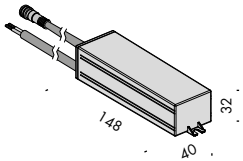

t4.421	25W	500mA	0,2
---------------	-----	-------	-----

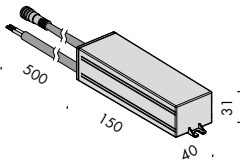

t4.413	30W	700mA	0,2
---------------	-----	-------	-----

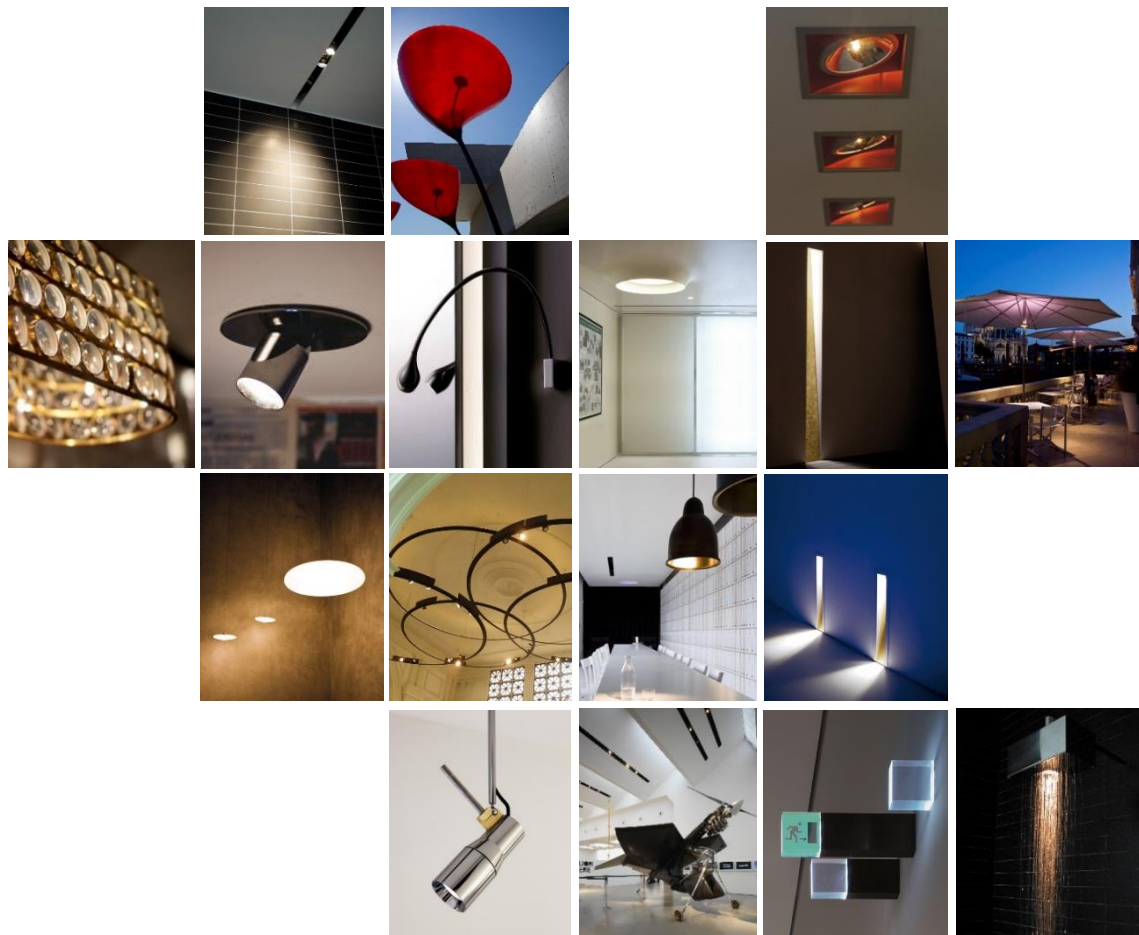

**Distributor for Viabizzuno
Architectural Lighting Solutions**

Web: www.cirruslighting.co.uk

Email: sales@cirruslighting.co.uk

Tel: 0207 193 2175

Fax: 0207 193 3175

